



**Stoneacre**  
Properties



## **Broomhill Crescent, Leeds, LS17 6HF**

### **£2,250 Per Calendar Month**

Stoneacre Properties are delighted to present this unique property in a sought after, quiet residential cul-de-sac.

As you approach the property you are greeted by a gated driveway, capable of holding up to six cars and two double detached garages.

As you enter the property you will find yourself in a large entrance hall leading to all areas of the property. The property briefly comprises of cloak room, downstairs shower room, living room, dining room, kitchen and separate utility room. To the first floor there is a spacious landing, Three double bedrooms and two smaller bedrooms, House bathroom and walk in wardrobe.

Contact our office to book your viewing today!

Available now!





Floor Plan

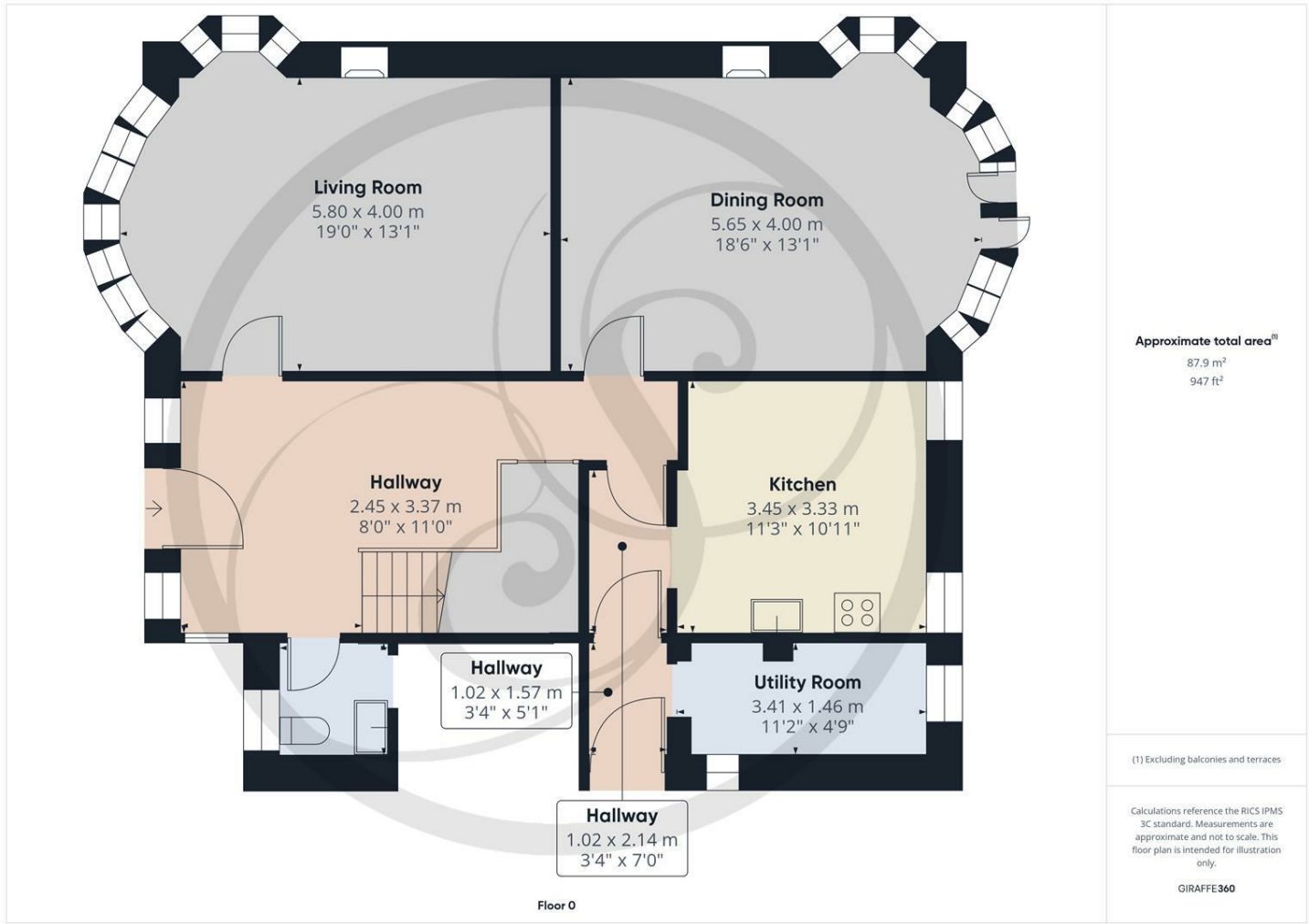

Area Map

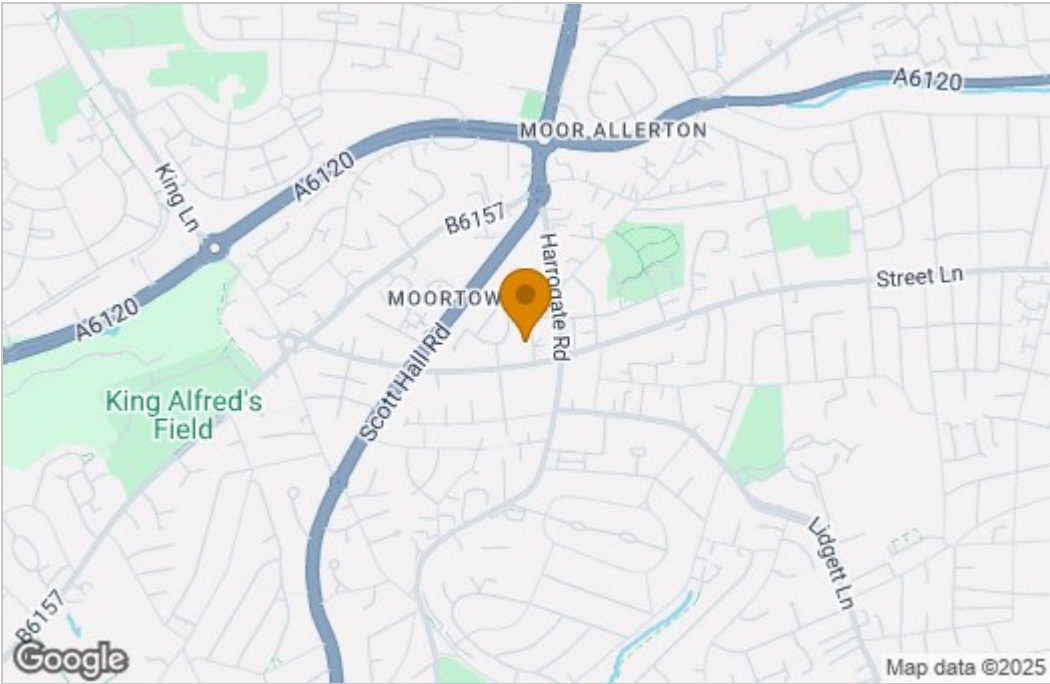

Energy Efficiency Graph

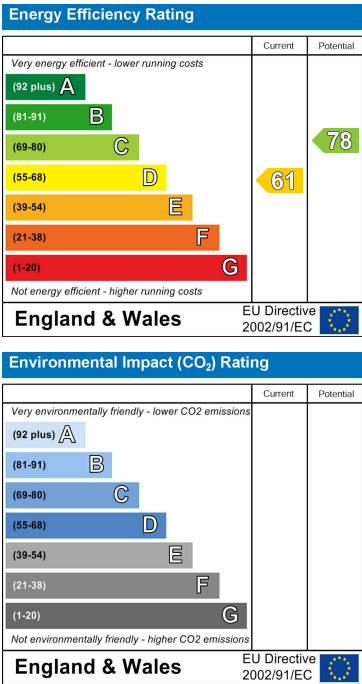

These particulars, whilst believed to be accurate are set out as a general outline only for guidance and do not constitute any part of an offer or contract. Intending purchasers should not rely on them as statements of representation of fact, but must satisfy themselves by inspection or otherwise as to their accuracy. No person in this firm's employment has the authority to make or give any representation or warranty in respect of the property.

